

## WATER PUMP PROTECTION

Ref.: 2CP2340085



PAP

**Assembly Booklet / Paper collection**

Livret de montage / Collecte de papier



LDPE

**Mini Zip Bag / Plastic collection**

Mini sac zip / Collecte de plastique



PAP

**Box / Paper collection**

Boîte / Collecte de papier



PAP

**Carton Separator / Paper collection**

Séparateur de cartons / Collecte de papier



C/PAP

**Card Header / Paper collection**

Carte d'en-tête / Collecte de papier



LDPE

**Plastic Bag Cover / Plastic collection**

Couverte de sac en plastique / Collecte de plastique



Management  
System  
ISO 9001:2015  
www.bvz.com  
© 9/2007/7728

## ASSEMBLY INSTRUCTION / INSTRUÇÃO DE MONTAGEM

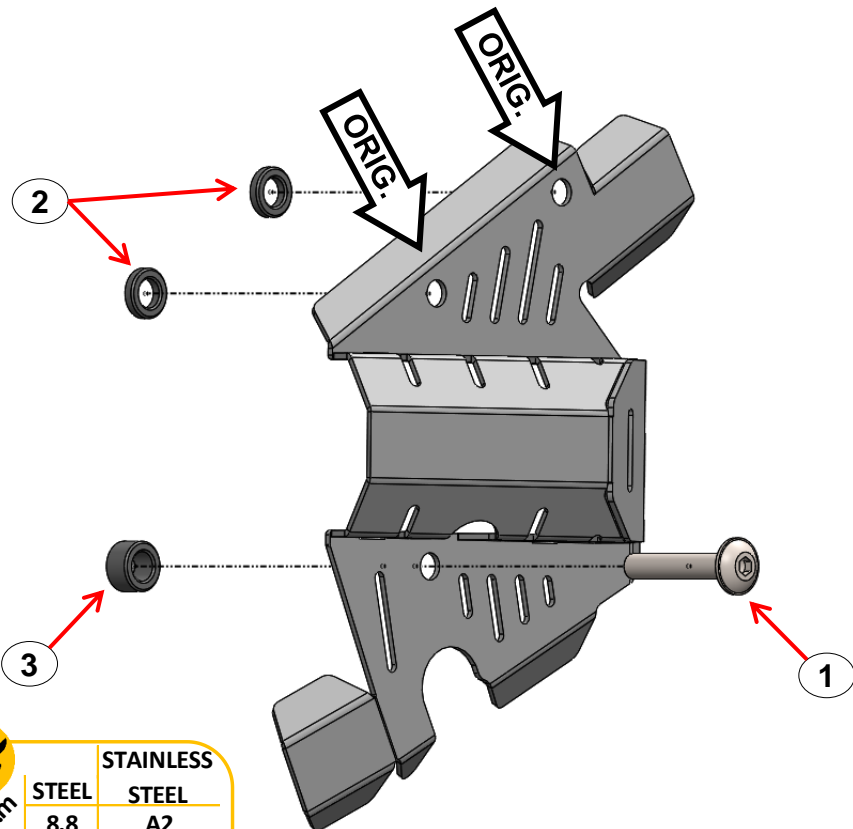
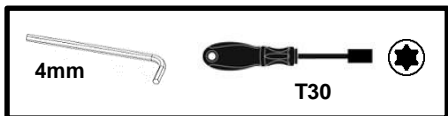

Nm	STAINLESS	
	STEEL	STEEL
M4	8.8	A2
M5	2.7	2.6
M6	5.5	5.1
M8	9.7	8.7
M10	23.0	21.2
M12	47.0	42.0
M12	80.0	73.0

ITEM Nº:	COMPONENTE (COMPONENT):	DESCRIÇÃO (DESCRIPTION):	QUANT.:
3	Casquilho Alumínio / Aluminum Bushing	Ø12xØ7x7	1
2	Casquilho Alumínio / Aluminum Bushing	Ø12xØ7x3	2
1	Paraf. Cabeça Redonda Sext. Int. c. FA / Screw Round Head With Washer False	M6x40 - ISO 7380	1
ACESSÓRIOS (ACCESSORIES)			

## WATER PUMP PROTECTION

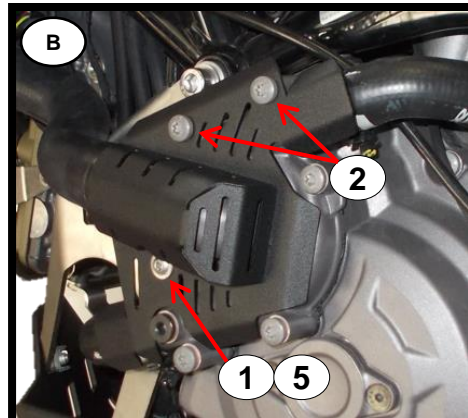
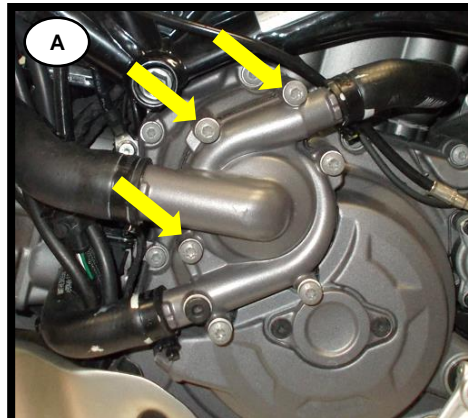

**English:**  
**Attention:** Follow the installation sequence as shown in the the photos.  
 • **Photo A:** Remove origine screws shown in the photo.  
 • **Photo B:** Attach the new protection parts using the diagram shown to ensure the correct position of bushings and screws.  
**Add a little medium strength loctite and torque all screws to the correct value.**

**Português:**  
**Atenção –** Seguir a sequência de montagem que pode ver nas fotos.  
 • **Foto A:** Remover parafusos de origem marcados na foto.  
 • **Foto B:** Montar proteção como a instrução de montagem para garantir a posição correta dos casquilhos e dos parafusos.  
**Adicionar um pouco de loctite nos parafusos e apertar todos os parafusos com o valor correto de torque.**

**Français:**  
**Attention:** Suivre la séquence de photos d'assemblage.  
 • **Photo A:** Enlever les vis d'origine marqués sur la photo.  
 • **Photo B:** Assembler la protection selon les instructions de montage por assurer la position correcte des douilles et des vis.  
**Ajouter un peu de loctite sur les vis et torque toutes les vis avec le bonne valeur.**